

MPCH1060LR45

Aliases (UPIC1060LR4500)

KEMET, MPCH, Power, 0.45 uH, 20%, 1060(4739)

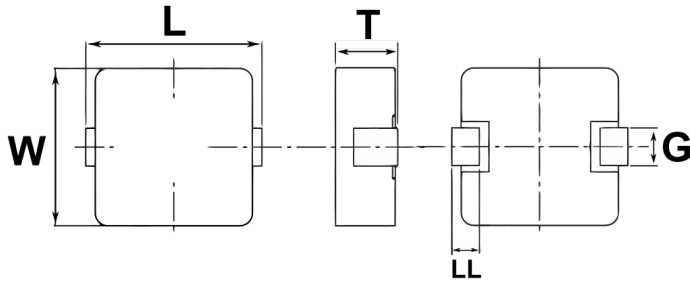

Click [here](#) for the 3D model.

Dimensions

L	12mm MAX
W	10mm +/-0.3mm
T	6mm MAX
LL	2.1mm NOM
G	3.5mm +/-0.5mm

Packaging Specifications

Packaging	T&R, 380mm
Packaging Quantity	500

General Information

Series	MPCH
Style	SMD
Chip Size	1060(4739)
Description	Shielded, Surface Mount Inductor
Features	Large Current Inductors
RoHS	Yes
Core	Composite
Miscellaneous	40 (K) Temperature Rise Max.

Specifications

Inductance	0.45 uH
Inductance Tolerance	20%
Temperature Range	-40/+125°C
Rated Temperature	120°C
Shielded	Yes
Current	32 A (Isat, 20% Drop In Inductance), 32 A (Irms, 40C Rise By Self Heating)
DC Resistance	0.76 mOhms